

FOR SALE



678 LIQUIDATE

DIRECT FURNITURE

43,000 VPD

1517 Southlake Parkway
Morrow, GA 30260
North Clayton/Airport Submarket

COMMERCIAL SITE
FOR SALE
\$350,000

ZONED GC
WHICH ALLOWS

- General Retail
- Restaurant
- Medical
- Hotel
- And other approved land uses

CENTRAL LOCATION TO 3 MAJOR SHOPPING DISTRICTS

- 0.77 Acres (200' x 175' Deep)
- Southlake Mall / Southlake Festival Shopping Center location
- High daily traffic count of 30,700±
- 10 major car dealerships close by
- 200' of frontage on Southlake Parkway
- Population Growth 2023 - 2.86%
- General Commercial zoning (GC) - City of Morrow

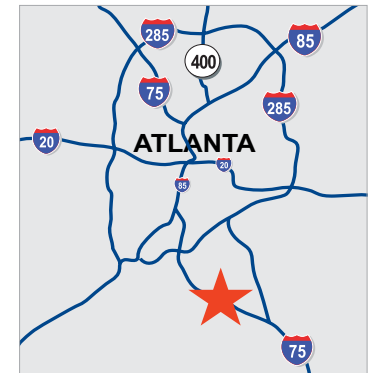

Ackerman & Co.

LARRY WOOD
770.913.3902
lwood@ackermanco.net

www.ackermanco.com

COMMERCIAL SITE FOR SALE

1517 Southlake Parkway, Morrow, GA 30260



LARRY WOOD
770.913.3902 | lwood@ackermanco.net | www.ackermanco.com

Ackerman & Co.

©2023 Ackerman & Co. All rights reserved. While we have no reason to doubt the accuracy of the information provided from sources we deem reliable, we cannot guarantee it and therefore assume no liability for errors, omissions or changes to this content.

COMMERCIAL SITE FOR SALE

1517 Southlake Parkway, Morrow, GA 30260

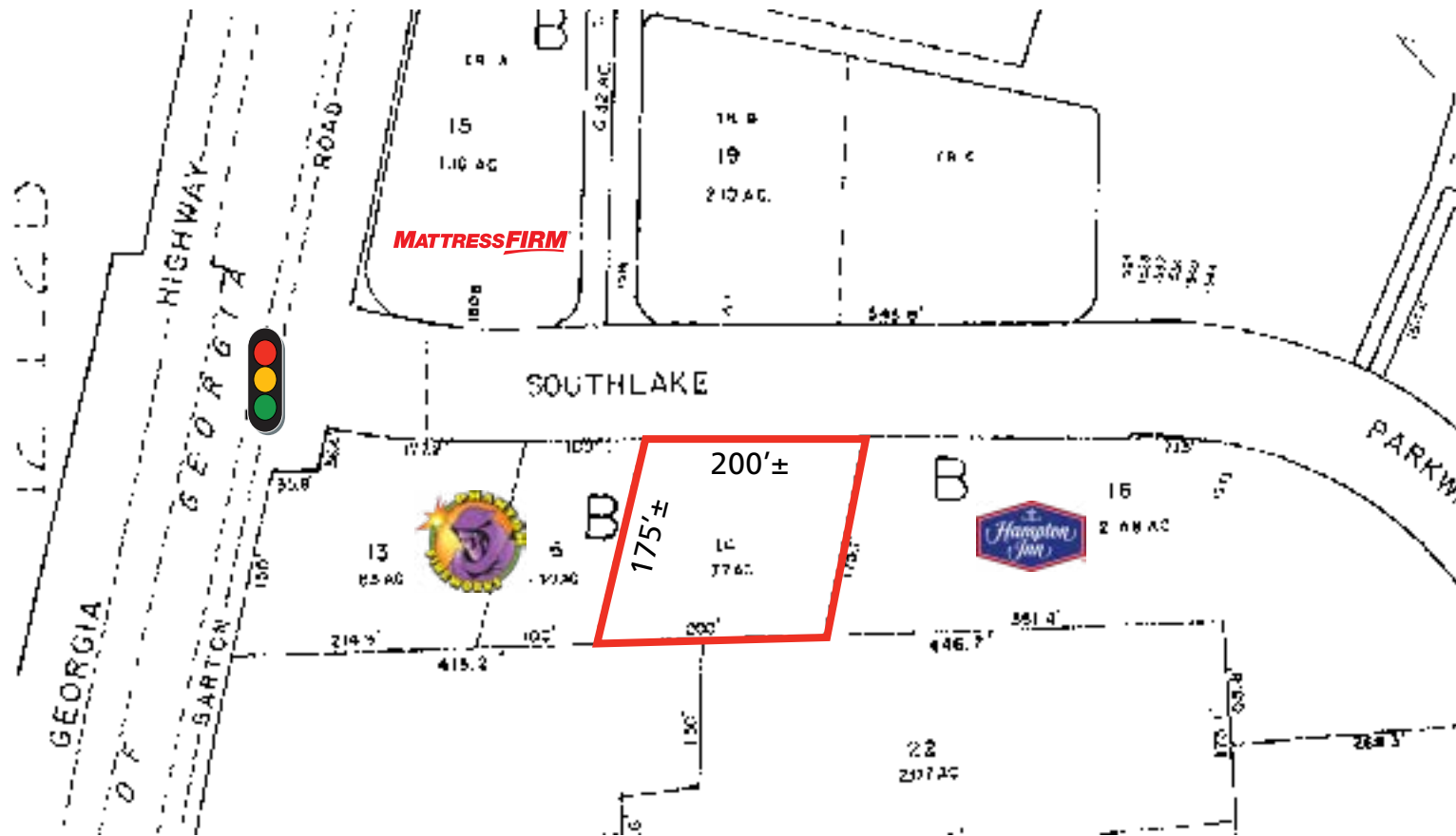

DEMOGRAPHICS

	1-MILE	3-MILE	5-MILE
Population	5,698	80,412	191,182
Average Household Income	\$69,289	\$66,995	\$72,985
Number of Households	2,397	28,801	69,550

LARRY WOOD
770.913.3902 | lwood@ackermanco.net | www.ackermanco.com

Ackerman & Co.

©2023 Ackerman & Co. All rights reserved. While we have no reason to doubt the accuracy of the information provided from sources we deem reliable, we cannot guarantee it and therefore assume no liability for errors, omissions or changes to this content.