

FOR  
LEASE

# BROCKETT SQUARE

3853 Lawrenceville Hwy, Tucker, GA 30084





100% LEASED

## PROPERTY HIGHLIGHTS

- Located at the signalized intersection of Brockett Rd and Lawrenceville Hwy, in the City of Tucker
- Three access points, and 250 surface parking spaces
- A mix of longstanding national and local tenants, many of which have been in the center over 10 years
- Anchored by Value Village and Family Dollar
- Located 2.5 miles from I-285



## AREA DEMOGRAPHICS (2023):

	1-MILE	3-MILE	5-MILE
 POPULATION	8,436	86,803	269,179
 HOUSEHOLDS	3,426	34,752	101,481
 AVG HH INCOME	\$114,248	\$107,681	\$98,424

COURTNEY BRUMBELOW

P: 770.913.3905

E: cbrumbelow@ackermanco.net

Ackerman Retail  
A DIVISION OF ACKERMAN & CO

# BROCKETT SQUARE

3853 Lawrenceville Hwy, Tucker, GA 30084

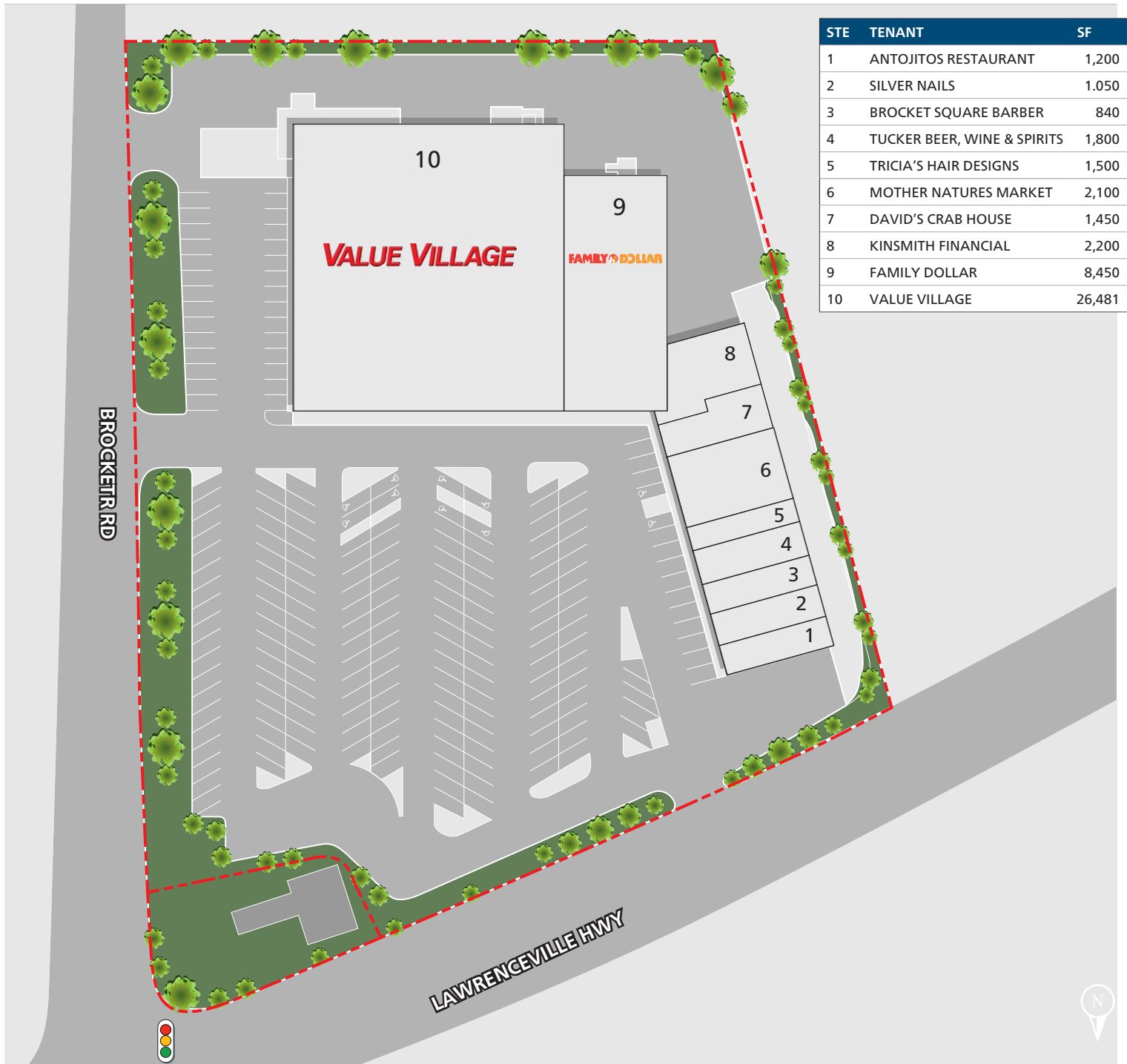

## Ackerman Retail

COURTNEY BRUMBELOW

P: 770.913.3905

E: cbrumbelow@ackermanco.net

©2023 Ackerman & Co. All rights reserved. While we have no reason to doubt the accuracy of the information provided from sources we deem reliable, we cannot guarantee it and therefore assume no liability for errors, omissions or changes to this content. Sources include CoStar, SitesUSA, ESRI, and Georgia DOT.

# BROCKETT SQUARE

3853 Lawrenceville Hwy, Tucker, GA 30084



## Ackerman Retail

COURTNEY BRUMBELOW

P: 770.913.3905

E: cbrumbelow@ackermanco.net

©2023 Ackerman & Co. All rights reserved. While we have no reason to doubt the accuracy of the information provided from sources we deem reliable, we cannot guarantee it and therefore assume no liability for errors, omissions or changes to this content. Sources include CoStar, SitesUSA, ESRI, and Georgia DOT.