

3630 Peachtree Road

Atlanta, Georgia 30326 | Fulton County



OFFICE SPACE FOR SUBLEASE

SPACE AVAILABLE 2,559 SF

LEASE RATE \$37.00/SF Full-service

SUITE HIGHLIGHTS

- Up to 2,559 sf - space sharing arrangement possible
- Sublease through 6/30/2020
- Five offices, conference, and work room
- Tenth floor with great views
- Furniture available
- Open break area

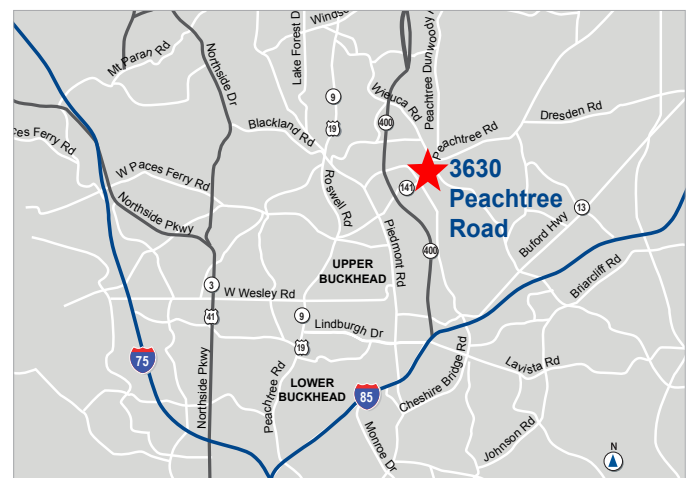

FOR MORE INFORMATION, CONTACT:

KEVIN HERMETZ

770.913.3942 | khermetz@ackermanco.net

©2018 Ackerman & Co. All rights reserved. While we have no reason to doubt the accuracy of the information provided from sources we deem reliable, we cannot guarantee it and therefore assume no liability for errors, omissions or changes to this content.

Ackerman & Co.

3630 Peachtree Road

Office Space for Sublease: 2,559 SF

Atlanta, Georgia 30326
Fulton County

FLOOR PLAN

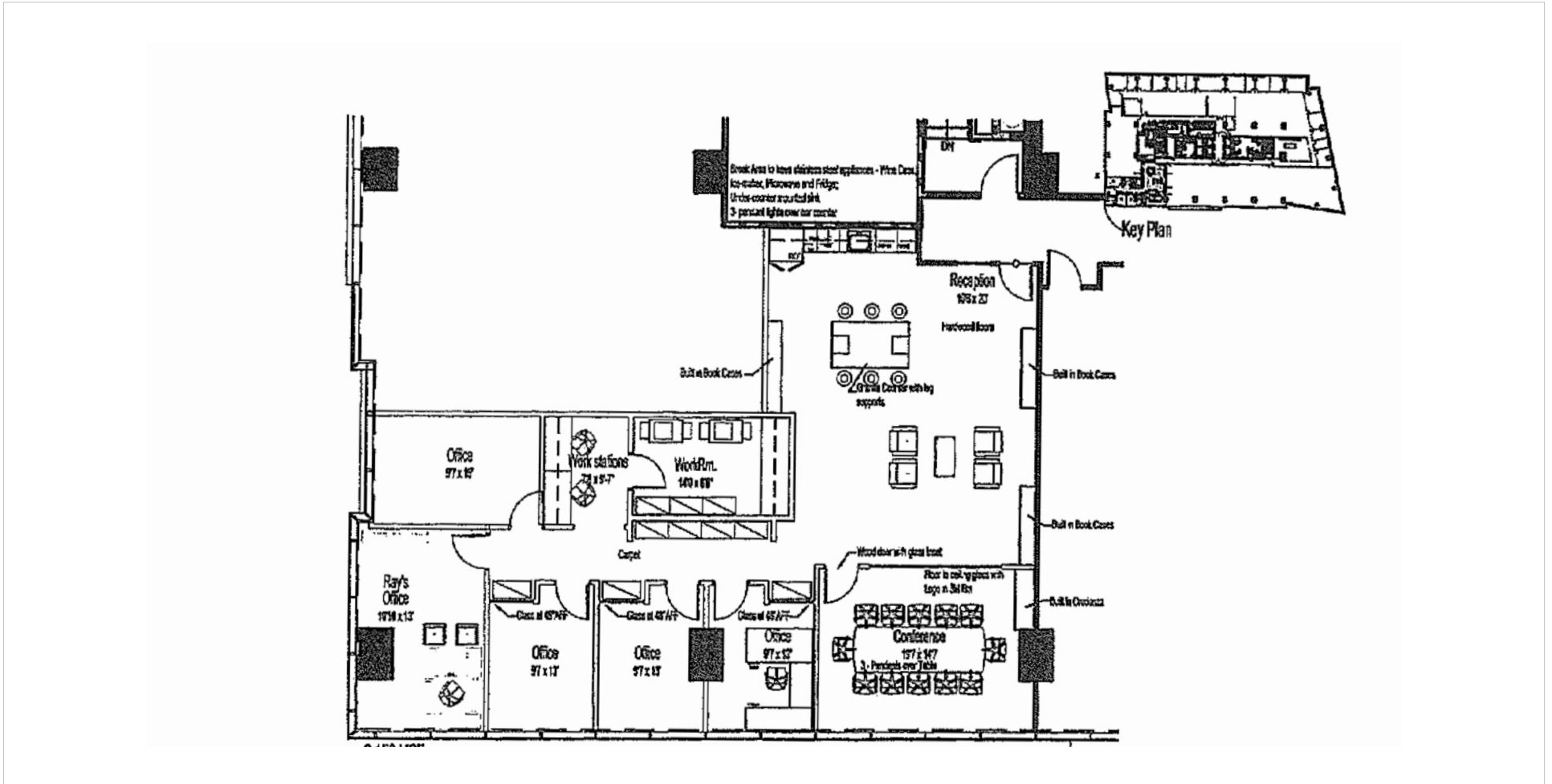

KEVIN HERMETZ

770.913.3942 | khermetz@ackermanco.net

www.ackermanco.com

Ackerman & Co.

3630 Peachtree Road

Office Space for Sublease: 2,559 SF

Atlanta, Georgia 30326
Fulton County

INTERIOR PHOTOS



BUILDING HIGHLIGHTS

- PARKING 2.6/1000
- CLASS A+ BUILDING IN THE HEART OF BUCKHEAD
- FIVE INGRESS / EGRESS POINTS ONTO PEACHTREE ROAD, WIEUCA ROAD, PEACHTREE DUNWOODY ROAD AND PHIPPS BOULEVARD
- CLOSE PROXIMITY TO PHIPPS PLAZA AND LENOX MALL
- CONFERENCE FACILITY
- FITNESS CENTER
- BUILDING CAFE AND TWO RESTAURANTS (F&B AND TOMO)
- COVERED DECK PARKING
- LEED CERTIFIED

KEVIN HERMETZ

770.913.3942 | khermetz@ackermanco.net

www.ackermanco.com

Ackerman & Co.