

# Highway 92 and Lee Road

Douglasville, GA 30135 | Douglas County



## COMMERCIAL SITES FOR SALE

### HIGHLIGHTS

- Traffic signal at Lee Road and Highway 92
- Daily traffic count is 30,000 ±
- Graded sites with utilities
- Interchange improvements at Lee Road and I-20
- Lee Road widening project started
- Zoned C-G-C, Douglas County
- Property is located in Highway 92 Village Overlay District
- Adjacent to Tractor Supply, Walgreens and RaceTrac.



Ackerman & Co.

LARRY WOOD  
770.913.3902  
lwood@ackermanco.net



KYLE GABLE  
404.867.3332  
kgable@pioneerlandga.com

# Highway 92 and Lee Road

Douglasville, Georgia 30135  
Douglas County

AERIAL



Ackerman & Co.

LARRY WOOD  
770.913.3902  
lwood@ackermanco.net



KYLE GABLE  
404.867.3332  
kgable@pioneerlandga.com

# Highway 92 and Lee Road

Douglasville, Georgia 30135  
Douglas County

## DEVELOPED OUT-PARCEL SITES

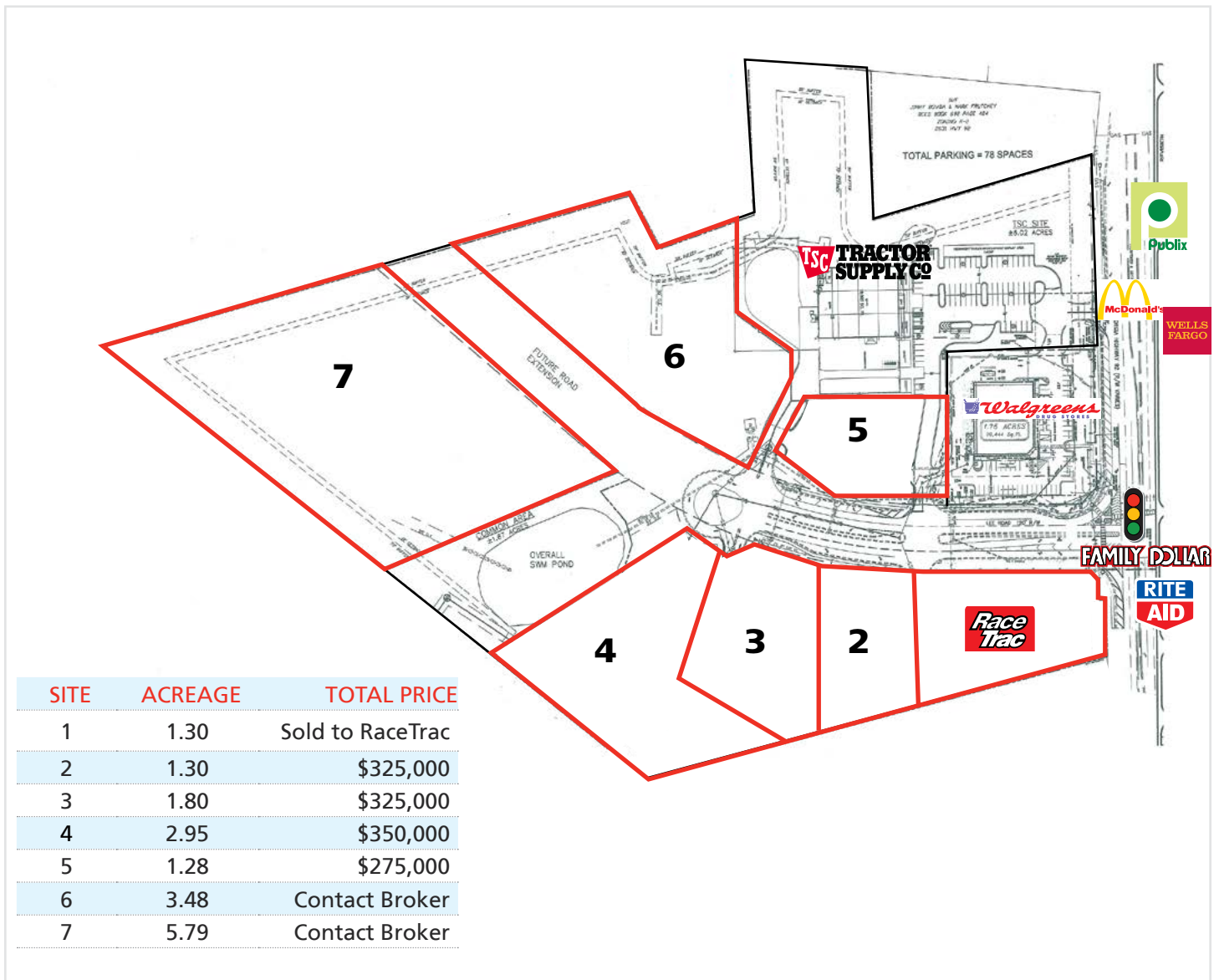

SITE	ACREAGE	TOTAL PRICE
1	1.30	Sold to RaceTrac
2	1.30	\$325,000
3	1.80	\$325,000
4	2.95	\$350,000
5	1.28	\$275,000
6	3.48	Contact Broker
7	5.79	Contact Broker

DEMOGRAPHICS	1-MILE	3-MILE	5-MILE
Population	5,104	28,948	84,702
Average Household Income	\$58,059	\$68,805	\$67,535
Number of Households	1,713	10,018	29,747

Ackerman & Co.

LARRY WOOD  
770.913.3902  
lwood@ackermanco.net



KYLE GABLE  
404.867.3332  
kgable@pioneerlandga.com